

KTT881-R

TEZ8 Vacuum Pump Repair & Maintenance Kit

Keep chamber and rotor surfaces clean and free of debris.

When completing reassembly, visually align the top of each end plate to the top of the black exhaust manifold so that the top surfaces (A) are parallel.

Note: Apply light amount of premium vacuum pump oil to each vane, o-ring, and rotor as you reassemble the pump.

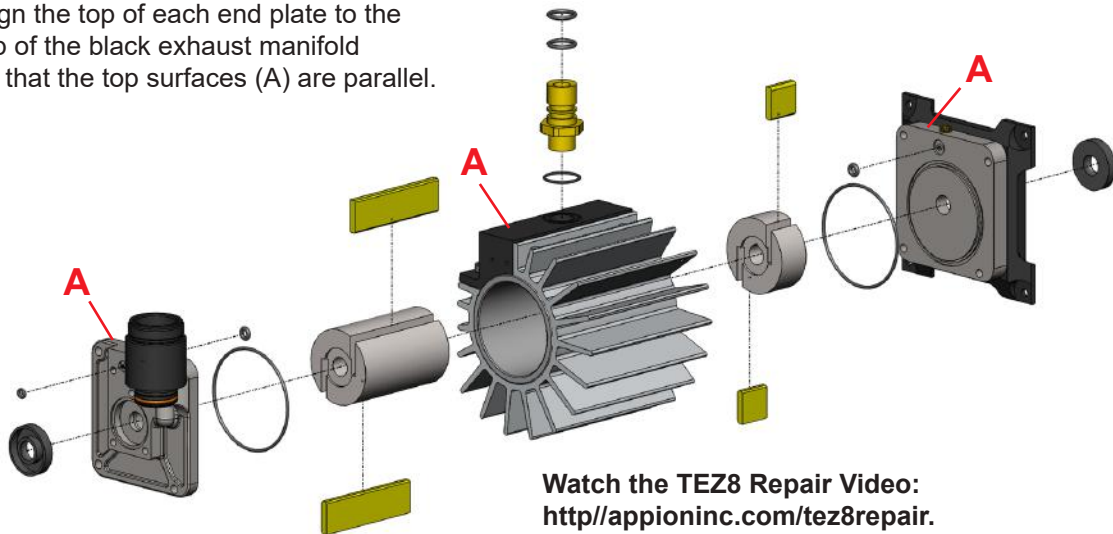

Watch the TEZ8 Repair Video:
<http://appioninc.com/tez8repair>.

Large Rotor Vane Orientation

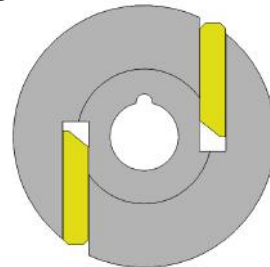

Small Rotor Vane Orientation

